

Tandberg Data DAT320 USB  
 External Tape Drives

# QUICK START

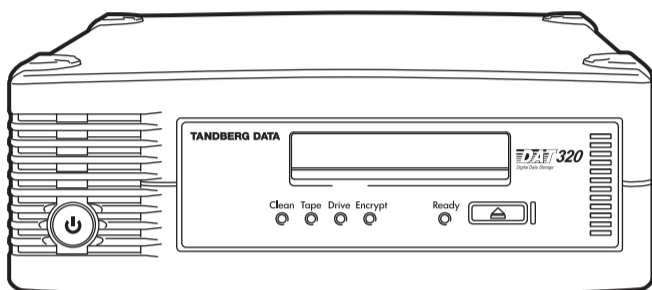

## 1 Introduction

This poster describes how to install your Tandberg Data DAT320 tape drive.

- Always connect to a USB 2.0 port (on a computer running Windows or Linux).
- The tape drive should be the only device on the USB hub.
- Use the correct driver.
- Use the supplied power cable to connect to the mains power supply. (The drive is not powered from the USB bus.)

## 2 Preparing the host

**IMPORTANT:** Refer to [www.tandbergdata.com](http://www.tandbergdata.com) for detailed compatibility information about operating systems and software applications.

### USB port

You must connect to a dedicated USB 2.0 port on your computer. USB 1.1 will severely degrade performance.

### Drivers

For Windows systems, download the latest drivers from [www.tandbergdata.com](http://www.tandbergdata.com). For other operating systems, patch to the latest version of the operating system, following the instructions in the patch documentation.

### Backup software

Always **upgrade** your software application to ensure it works correctly with the tape drive. We do **NOT** recommend native backup applications, such as Windows Backup, because they do not support the full features of the tape drive and may cause performance problems.

**NOTE:** Some backup applications require you to use their own drivers. Refer to the documentation of your software application to ensure you are using the recommended driver.

### Power requirements

An external Tandberg Data DAT320 tape drive will operate using any voltage in the range 100-240 volts (0.7A, 50-60 Hz). No adjustment is needed. A suitable power cable for your geographical location is provided with the tape drive.

## 3 Connecting the tape drive

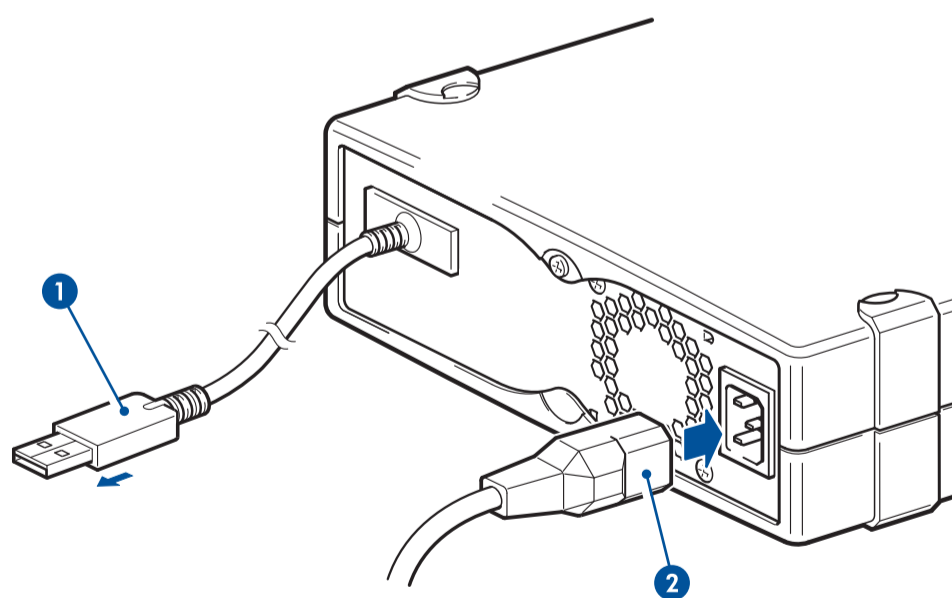

1 USB cable    2 Power cable

### USB cable

The USB cable is pre-fitted to your tape drive; you cannot remove it. Plug the cable into the USB port on your computer. The tape drive can be connected to a USB HUB, but it should be the only device connected to the USB hub.

### Power cord

Use the supplied, approved power cord (2). This cord is appropriate for your specific geographic region.



Printed on at least 50% total recycled fiber with at least 10% post-consumer paper

© 2009 Tandberg Data

Printed in the EU

[www.tandbergdata.com](http://www.tandbergdata.com)

Part No. 1018930



## 4 Power on the tape drive and verify connection

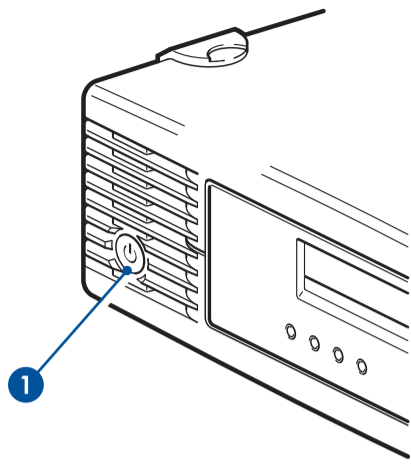

1 Power button

- Power on the tape drive using the power button located at the front of the tape drive.
- Check the LEDs on the front panel to make sure the tape drive is ready for use (See section 6: Understanding the LEDs).
- Verify the connection.

## 5 Choosing and looking after media

Your high-performance tape drive works best with high-performance Tandberg Data DAT media. For optimum performance always use a data cartridge that matches the specification of your tape drive (see table) and normally only use one cartridge per day.

**NOTE:** The DAT320 tape drive is not compatible with 4mm media. It may only be used with 8mm media.

Table: Tandberg Data DAT data cartridge compatibility

	DAT72 & All DDS	DAT160	DAT320
Tandberg Data DAT320	Not Supported	Read/Write	Read/Write (Recommended)

\* Capacity assumes 2:1 compression.

The recommended cleaning cartridge is the Tandberg Data DAT320 cleaning cartridge for DAT320 tape drives. Only use the cleaning cartridge if the Clean LED is flashing.

### It pays to look after your media

Many tape drive and backup failures are caused by damaged or badly handled tape media.

- Keep media in the case provided.
- Follow the temperature, humidity and acclimatization guidelines on the media packaging.
- Avoid dropping it or rough handling, as this is likely to damage the cartridge.
- Inspect it regularly for damage.
- Do not exceed normal cartridge life.

For detailed information on media care and best handling please visit [www.tandbergdata.com](http://www.tandbergdata.com).

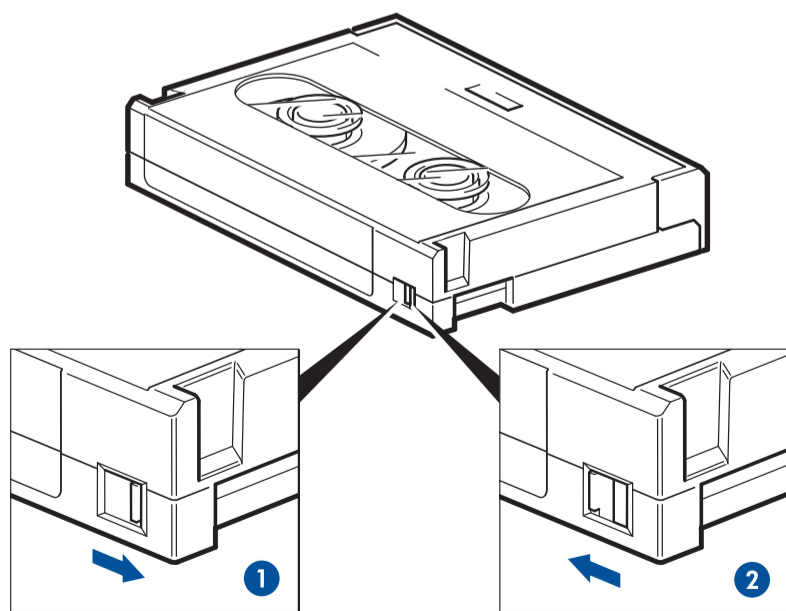

1 Write-protect switch off 2 Write-protect switch on

## 6 Understanding the LEDs

### DAT320

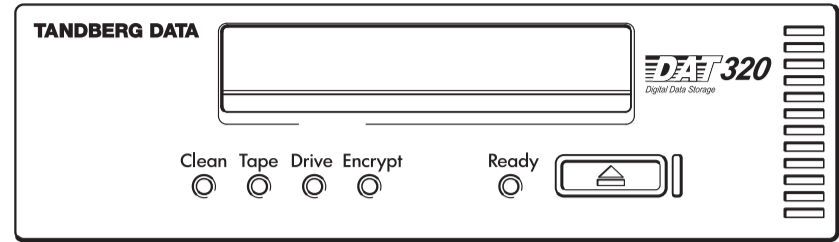

#### Clean – amber

- Off: the drive does not require cleaning
- Flashing: the drive needs cleaning
- Flashing (with Ready flashing): Cleaning is in progress

#### Tape – amber

- Off: no fault has been detected
- Flashing: the drive believes the current tape or the tape just ejected is faulty (damaged or unsupported)
- Flashing (with Ready and Clean flashing): the cleaning cartridge has expired. The drive ejects it automatically

#### Drive – amber

- Off: no fault has been detected
- Flashing: the drive mechanism has detected a hardware error

#### Encrypt – blue

- Off: no encryption activity, encryption parameters are not loaded
- On: encryption parameters loaded, drive is ready to read/write encrypted data
- Flashing blue (with Ready flashing): Reading/writing encrypted data
- Solid blue (with Ready flashing): Encryption parameters loaded, but drive is reading/writing unencrypted data. This is the normal Ready LED operation
- Fast flash (with Drive LED): encryption related error

#### Ready – green

- On: the drive is ready for use and there is a cartridge in the drive
- Off: there is no cartridge in the drive. If the Ready LED remains off when a cartridge is loaded, the drive power may be off or there may have been a failure during self-test
- Flashing: the drive is busy

## 7 Hardware encryption

The DAT320 tape drive includes hardware capable of supporting data encryption. To make use of this feature you need a backup application that supports hardware encryption and DAT320 media.

## 8 Other sources of information

There is a more detailed "User Guide" on [www.tandbergdata.com](http://www.tandbergdata.com).

If you need technical support or have any problem with your DAT320 tape storage solution, please visit the support pages at [www.tandbergdata.com](http://www.tandbergdata.com).